



Meadowbank , NSW

 1  1  1

SUNDRENCHED APARTMENT IN VIBRANT LOCATION - TOP FLOOR

This spectacular east facing apartment is perfectly situated to take full advantage of a lifestyle at the heart of one of Sydney's most vibrant precincts.

Offering a sundrenched and serene idyll which enjoys the many benefits of the local community.

KEY FEATURES

The layout ? Capitalising on its easterly outlook, that takes in both scenic & water views towards Breakfast Point, this property allows sunlight to flow over the balcony and through into the bedroom and living area while the kitchen and bathroom flank the entrance hallway.

The features ? This apartment features air-conditioning, a modern kitchen with stone benchtops and gas cooking, streamline bathro

By Negotiation | Top Floor

Type: Apartment
Council Rates: \$315.00 p/q
Water Rates: \$170.00 p/q



Tim Lapham
0424 509 961

Danielle Gersbach
0413 101 352

35/2 Underdale Lane, Meadowbank

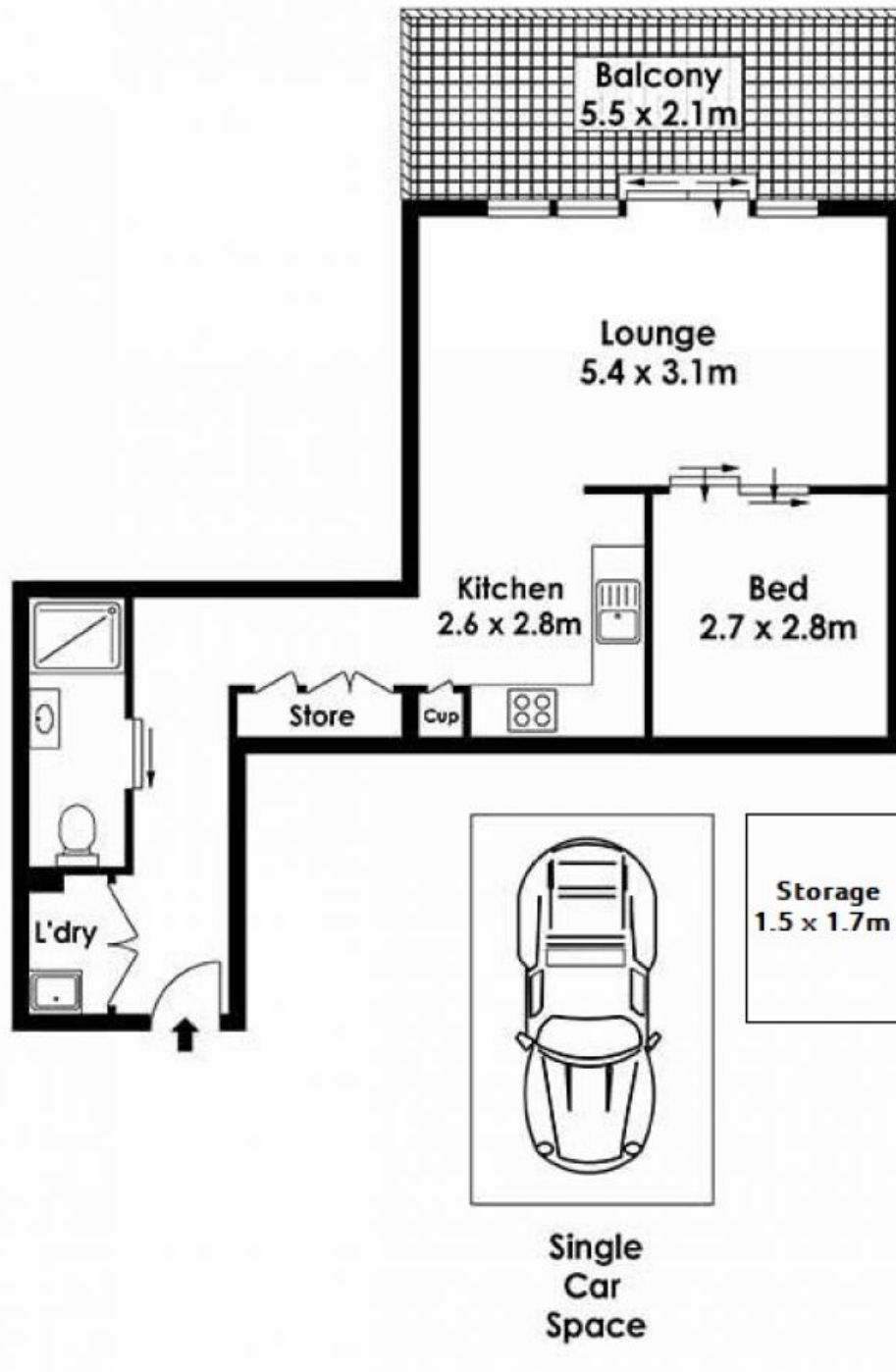

The information above is provided in good faith and has been provide to us from a variety of sources. We have not verified whether the information is accurate and do not have any belief one way or other in its accuracy. We do not accept any responsibility to any person for its accuracy and do no more than pass it on. All interested parties should rely on their own inquiries in order to determine whether or not this information is in fact accurate.

Floor Plan by www.squaremeter.com.au