



**WATERPOINT**  
ASSET MANAGEMENT



 **waterpoint**  
asset management



Sydney Olympic Park , NSW



## NOW LEASED

APPLY BY SCANNING OUR QR CODE IN THE PHOTO GALLERY OR COPY AND PASTE THIS LINK INTO YOUR BROWSER: [t-app.com.au/wam](https://t-app.com.au/wam)

Situated in the highly sought after Australia Towers Development in Sydney Olympic Park, this design offers a modern open plan, which flows from kitchen through to the lounge and outdoor balcony.

- Generous layout with study
- Air-conditioned, Built-in-robos
- 9ft high ceilings, double glazed windows
- Upgraded kitchen with ILVE appliances, stone benchtop
- Designer finished tiles in bathroom and ensuite
- Internal laundry with washer/dryer combination
- Security parking, basement lock-up storage

**\$480 pw**

**Type:** Unit

**Date Available:** 12/09/2022

**Ranee  
Durdag**

0450 013 561

[www.waterpoint.com.au](https://www.waterpoint.com.au)

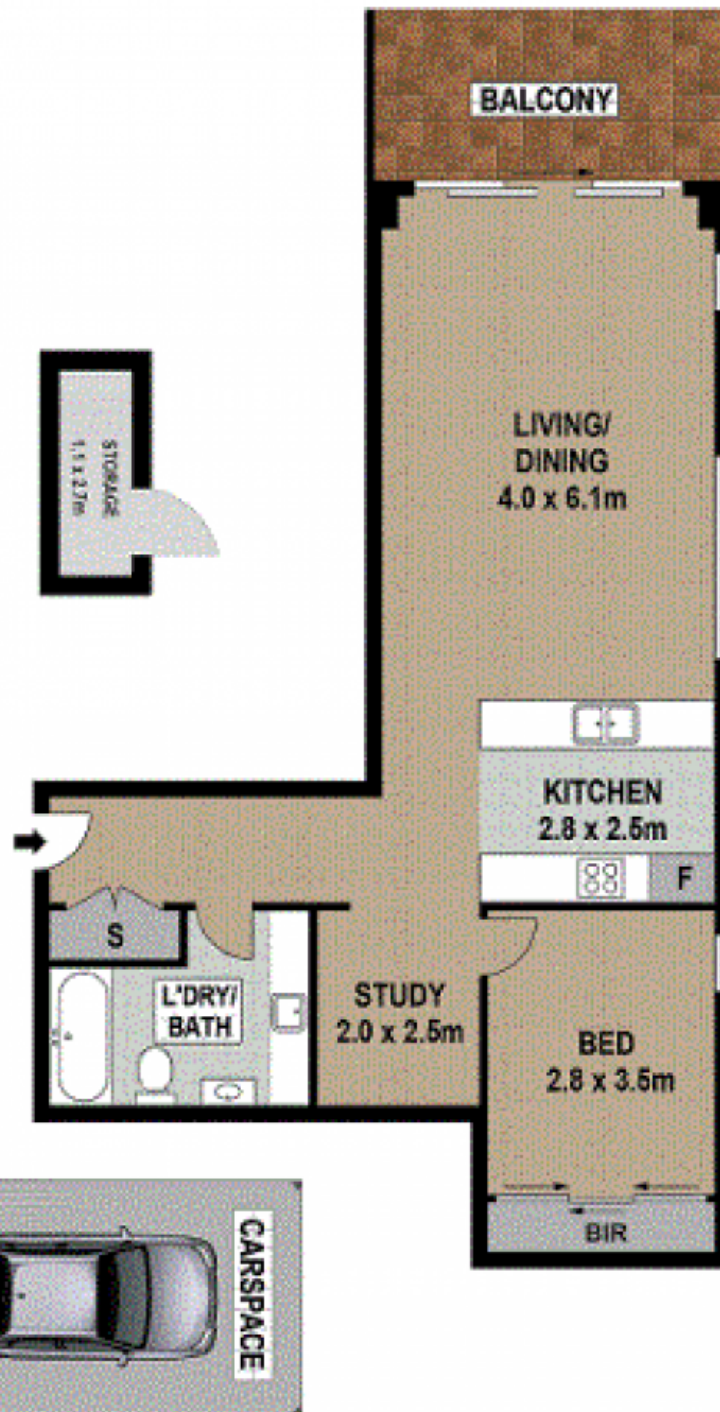

Scale in metres, indicative only. Dimensions are approximate. All information contained herein is gathered from sources we believe to be reliable. However we cannot guarantee its accuracy and interested persons should rely on their own enquiries.



**305/9 Australia Avenue, Sydney Olympic Park**

Plan by Touchin Media

**305/9 Australia Avenue, Sydney Olympic Park NSW**