



WATERPOINT
ASSET MANAGEMENT



 **waterpoint**
asset management



Sydney Olympic Park , NSW



NOW LEASED

APPLY BY SCANNING OUR QR CODE IN THE PHOTO GALLERY OR COPY AND PASTE THIS LINK INTO YOUR BROWSER: t-app.com.au/wam

Situated in the highly sought after Australia Towers Development in Sydney Olympic Park, this design offers a modern open plan, which flows from kitchen through to the lounge and outdoor balcony.

- Generous layout with study
- Air-conditioned, Built-in-robos
- 9ft high ceilings, double glazed windows
- Upgraded kitchen with ILVE appliances, stone benchtop
- Designer finished tiles in bathroom and ensuite
- Internal laundry with washer/dryer combination
- Security parking, basement lock-up storage

\$480 pw

Type: Unit

Date Available: 12/09/2022

**Ranee
Durdag**

0450 013 561

www.waterpoint.com.au

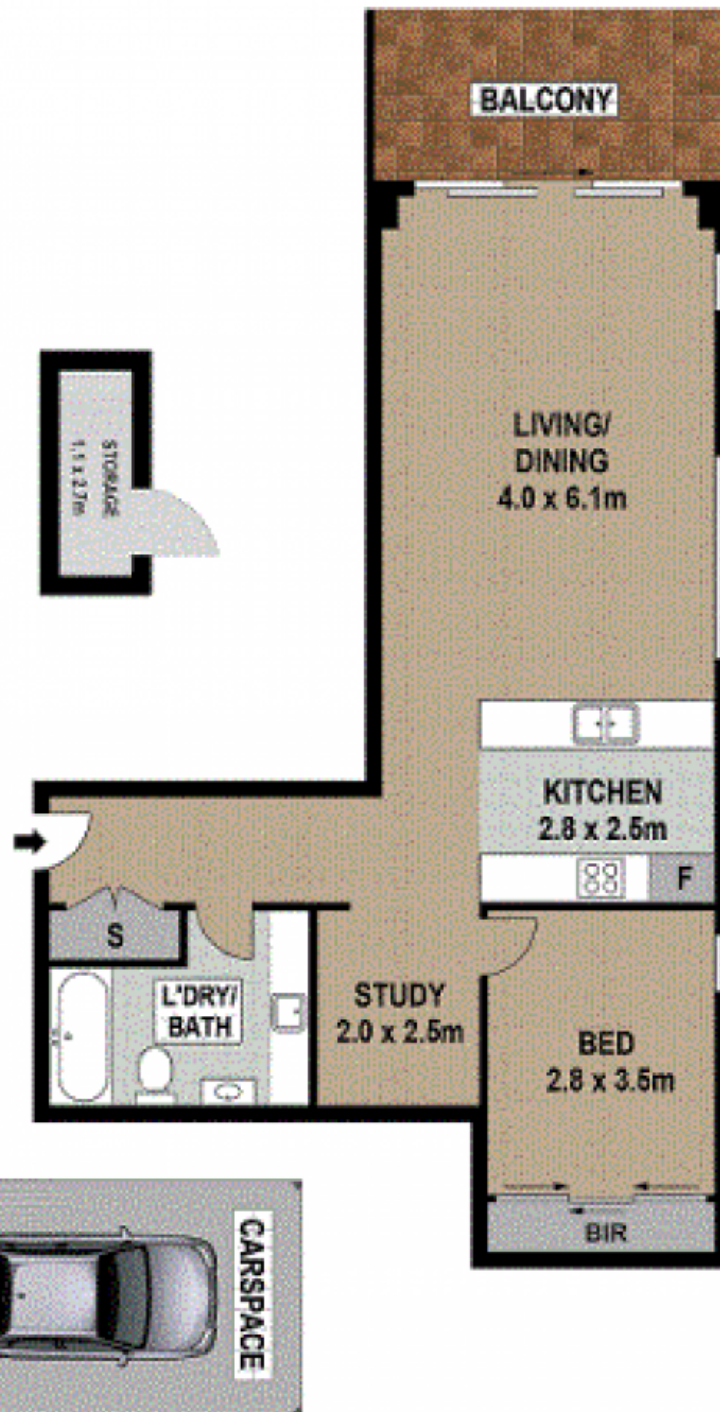

305/9 Australia Avenue, Sydney Olympic Park

305/9 Australia Avenue, Sydney Olympic Park NSW