



Chiswick , NSW



## LIFESTYLE | LOCATION | LIVING

This stunning 2 bedroom apartment situated in the highly sought after Artisan Development comprises the highest standard of luxury apartment living in the inner-west.

Surrounded by lush parkland and the bays of Sydney Harbour, this creative design combines resort living with village appeal and is perfectly situated for City buses and also for the Rivercat service, which is approximately 800 metres away and Abbotsford Public School as well as lots of other amenities.

The fully fitted kitchen complete with Caesarstone benchtops overlooks the open plan dining, lounge area which in turn flows out to the entertaining courtyard.

The master bedroom boasts a walk through robe to generous sized ensuite. The spacious second bedroom also features built in robe and balcony access.

**965000**

**Type:** Apartment  
**Sold Date:** 03/06/2023  
**Council Rates:** \$290.00 p/q  
**Water Rates:** \$180.00 p/q  
**Strata Rates:** \$1,300.00 p/q



**Tim Lapham**

0424 509 961

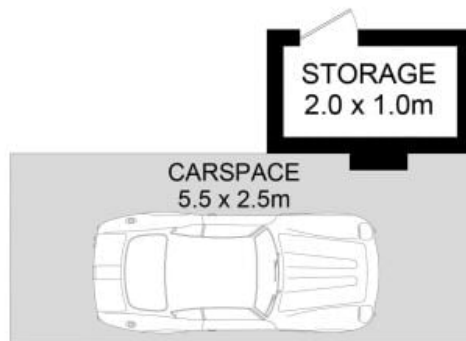
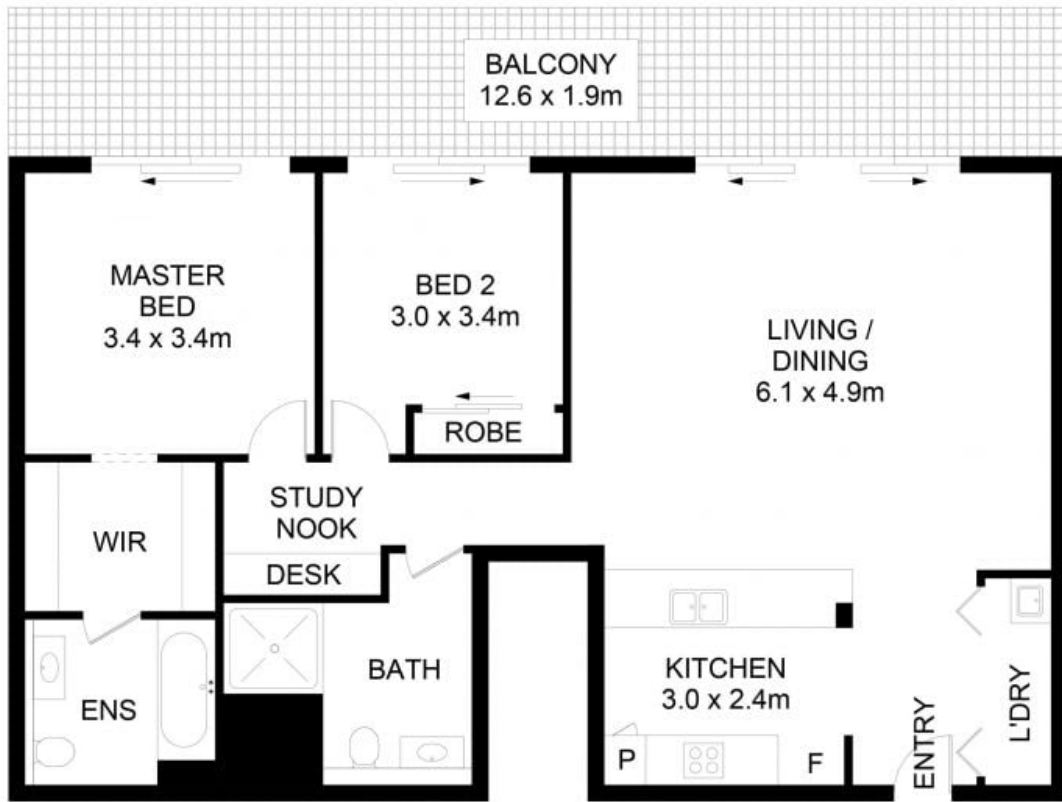

## 28/54A Blackwall Point Road, Chiswick

DISCLAIMER: No liability for the accuracy of details contained within our floor plans. All plans are drawn and also checked to the best of our ability, however information contained in our floor plans such as area calculations are approximate, and have not been surveyed or drawn to scale. Our floor plans are for representational purposes only and should be used as such. Do not attempt to refer to our floor plans for structural or detailed information.



28/54A Blackwall Point Road, Chiswick NSW